



Crewsaver
Safer By Design

USER MANUAL



MARIN 290 LIFEJACKET

ART0603 I3

MARIN 290 LIFEJACKET

GENERAL DESCRIPTION

The MARIN 290 range of Lifejackets are designed for use by the forces. The high buoyancy level provides added protection when heavy work gear, equipment or clothing is worn. These Lifejackets have a single chamber fitted with a 60g CO₂ cylinder ensuring full buoyancy of 290N is achieved during inflation. The MARIN 290 Lifejackets have a yellow Polyurethane coated nylon bladder with x8 pieces of reflective tape (covered by default), a whistle located on the edge of the bladder and an MED approved light.

The MARIN 290 Lifejackets are available with an automatic firing mechanism. The automatic version can be converted to manual operation by simply covering the automatic capsule with a sealing cap (included in the cover).

The MARIN 290 can be worn attached to body armour, through the use of MOLLE webbing. It can also be worn as a standalone lifejacket with the included waistbelt and crotch straps attached.

STANDARD AUTOMATIC INFLATION

Automatic inflation of the Lifejacket is achieved by an efficient and lightweight automatic operating unit with replaceable capsule and CO₂ cylinder. Tests on this component have constantly shown 4 second inflation times from complete immersion. This unit can be manually operated by pulling down on the beaded handle located on the right hand side of the jacket.

MANUAL GAS INFLATION

The gas cylinder is fired manually by pulling the beaded handle located on the right hand side of the cover.

ORAL INFLATION

The lifejacket incorporates a mouth inflation tube for oral topping up and to allow for deflation after use.

LIGHT

The lifejacket is fitted with a MED approved light. No action by the user is required as the light will switch on automatically when the water-activated switch is fully immersed in water. The light can be turned off by pressing the button on top of the light unit.

**IMPORTANT
ONLY AUTHORISED PERSONNEL ARE PERMITTED TO
CARRY OUT THESE OPERATIONS**

BEFORE USE

These models are ready for use when purchased. However, the following checks must be made:

The operating head can be accessed by unzipping the zip located on the top neck part of the cover. Check that the automatic firing capsule (C) is screwed fully onto the operating mechanism (B). Ensure that the capsule (C) has not been fired inadvertently by checking that the bottom indicators show green (D). Also check the expiry date on the side of the capsule. Do not use a capsule that is out of date. Check the CO₂ cylinder (A) is securely screwed into the operating mechanism with EXOLOK mechanism and label (F) and fit mesh sleeve (G). Check that the top indicator (D) show green. Ensure pull handle (E) is located in the garage in the jacket cover and cord is not tangled or damaged.

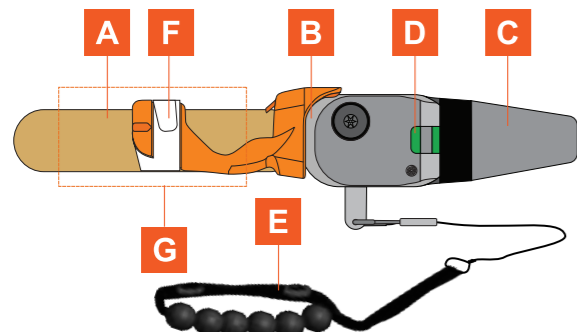

ADDITIONAL INFORMATION

STORAGE

At all times the jacket must be stored, preferably hung up, in a dry well ventilated area. Automatic lifejackets, exposed to any form of dampness during storage could result in spontaneous inflation. If the jacket becomes wet, it is necessary to unfold the jacket from its cover. Remove the automatic capsules if fitted and allow the lifejacket to dry naturally in a warm dry atmosphere. The automatic capsules should be stored in a dry place whilst the jacket is being dried out. Once the jacket is dry, the capsules may be refitted and the jacket repacked (See repacking instructions).

GENERAL

Only approved personnel should instruct on the correct donning, operation of inflation mechanisms and oral tube inflation of the lifejacket.

THIS LIFEJACKET MUST BE SERVICED, AT LEAST ONCE A YEAR UNDER NORMAL USE, BY AN APPROVED SERVICE AGENT.

IMPORTANT: THE LIFESPAN OF THE PRODUCT IS 10-YEARS WITH SERVICING YEARLY. EXTRA 4 YEARS WITH SERVICING EVERY 6 MONTHS.

WARNING: inflating your lifejacket using CO₂ inflation could over pressurise and damage the lifejacket if it has already been inflated orally.

Never use a lifejacket as a cushion or in any other way likely to cause damage.

WARNING: This lifejacket is inflated by a CO₂ gas cylinder! Gas cylinders are dangerous goods. They must be kept away from children and not misused.



Crewsaver

Survitec House, Lederle Lane, Gosport, Hampshire PO13 0FZ
Tel: +44(0) 1329 820000
Web: www.crewsaver.com

survitec

MARIN 290 BODY ARMOUR ATTACHMENT

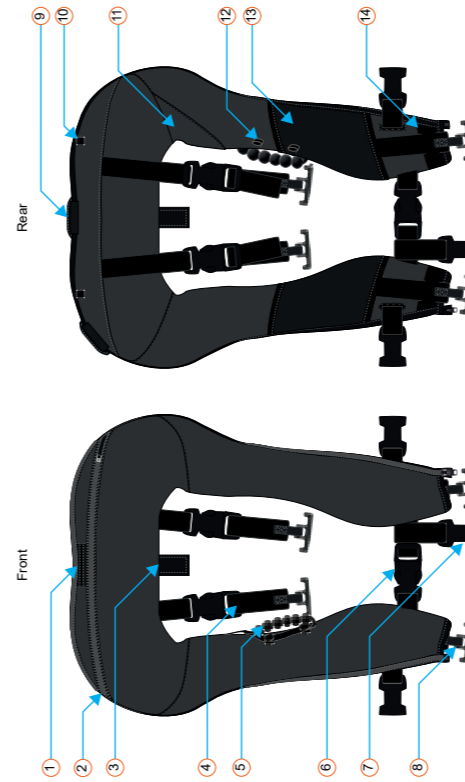

1. Glowstick pocket.
2. Ring mechanism inspection zip.
3. Ring mechanism inspection zip.
4. Ring mechanism inspection zip.
5. Ring mechanism inspection zip.
6. Ring mechanism inspection zip.
7. Ring mechanism inspection zip.
8. Ring mechanism inspection zip.
9. Burst point tabs.
10. Ring mechanism inspection zip.
11. Ring mechanism inspection zip.
12. Ring mechanism inspection zip.
13. Ring mechanism inspection zip.
14. Ring mechanism inspection zip.

MARIN 290 STANDALONE LIFEJACKET

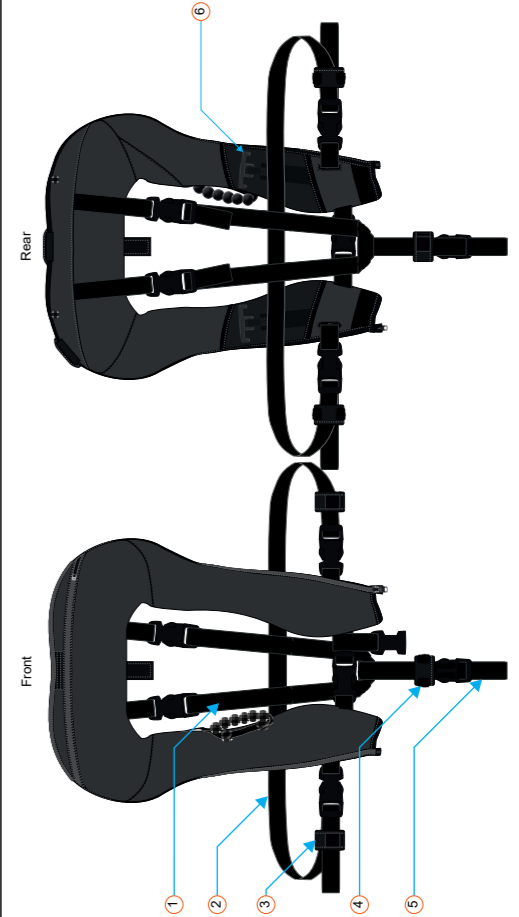

1. Rear crotch strap attachment clips.
2. Waist belt webbing.
3. Waist belt webbing ties.
4. Crotch strap webbing ties.
5. Crotch strap clip.
6. Front body armour webbing attachment clips tucked into ties.

** CROTCH STRAP OPTIONAL

MANUFACTURERS INFORMATION

The service label for the jacket is attached to the back neck of the bladder and it is visible when the inspection pocket is opened.

The label contains the service history and serial number of the jacket. The serial number also includes the date of manufacture.

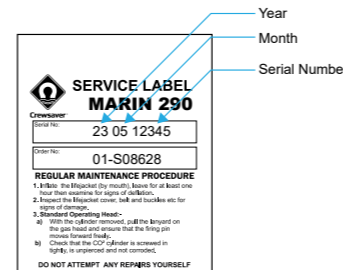

**IMPORTANT
THE LIFESPAN OF THE PRODUCT IS 10-YEARS WITH SERVICING YEARLY.
EXTRA 4 YEARS WITH SERVICING EVERY 6 MONTHS**

Included in the jacket is R16932 UMA8080 Pro Sensor Elite Sealing Cap and it allows the automatic mechanism to be converted to a manual mechanism by fitting the cap over the end of the firing mechanism. The cap sits within a mesh pocket on the inside top of the jacket.

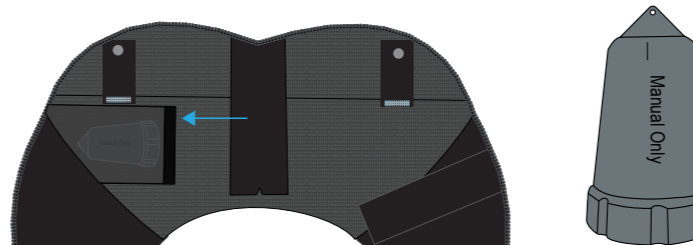

TESTING YOUR LIFEJACKET

Train yourself in the use of the device. In an emergency, there is no time to learn how the equipment works. Crewsaver recommend that you try your Lifejacket to ascertain its performance before use in an emergency. This will also help familiarise yourself with the product.

When trying out your Lifejacket, remember that you may need replacement parts or rearming kits to get your Lifejacket ready for use again.

**IMPORTANT
ONLY AUTHORISED PERSONNEL ARE PERMITTED TO
CARRY OUT THESE OPERATIONS**

AFTER USE

General:

a) Deflate the jacket completely by reversing the cap of the oral inflation tube and inserting it into the end of the tube. Remove as much gas as possible by squeezing the jacket. If the jacket was inflated by the CO₂ cylinder, care must be taken not to breathe in the expelled gas, otherwise discomfort in breathing will be experienced.

DO NOT USE A VACUUM PUMP TO DEFLATE THE LIFEJACKET

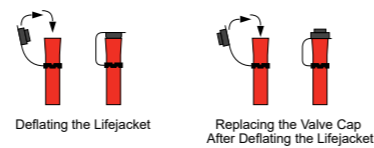

b) Unscrew the fired capsule before removing the spent cylinder.

c) If the Lifejacket has been in salt water or contaminated water, it is essential to rinse out in fresh water first. Hang the unfolded Lifejacket in a warm and dry atmosphere. Allow to dry out completely.

d) Once dry, inflate by mouth and check for damage. If damage has occurred, return to Crewsaver for repair or to their accredited agent. DO NOT ATTEMPT ANY REPAIRS YOURSELF OR ANY RIGHTS UNDER MANUFACTURERS GUARANTEE WILL BECOME VOID. Providing the jacket is sound, a new cylinder and capsule may be fitted to the lifejacket.

e) The MARIN 290 is fitted with an approved light. If the light has reached the expiry date the light must be replaced with a new approved unit.

f) The Lifejacket should now be repacked ready for use (see repacking instructions).

RE-ARMING YOUR AUTOMATIC OPERATING MECHANISM

Always re-arm your lifejacket ready for use before you stow it away. The operating mechanism must be thoroughly dried before re-arming. When re-arming your lifejacket it is important you use only Crewsaver supplied components. For your nearest supplier contact Crewsaver or see www.crewsaver.com

Take the new automatic firing capsule and screw onto the operating mechanism in a clockwise direction. Screw tightly ensuring there is no gap between the capsule and the base of the operating mechanism.

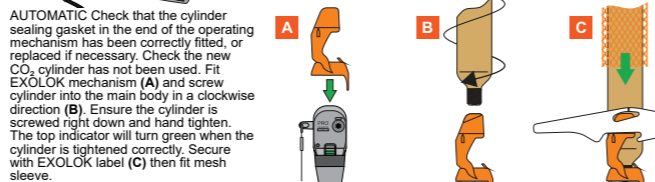

AUTOMATIC Check that the cylinder sealing gasket in the end of the operating mechanism has been correctly fitted, or replaced if necessary. Check the new CO₂ cylinder has not been used. Fit EXOLOK mechanism (A) and screw cylinder into the main body in a clockwise direction (B). Ensure the cylinder is screwed right down and hand tighten. The top indicator will turn green when the cylinder is tightened correctly. Secure with EXOLOK label (C) then fit mesh sleeve.

The operating mechanism is now re-armed. Both indicators should show green. DO NOT USE if either indicator is red. See www.uml.co.uk for more details on the UML Pro-Elite Mechanism.

CREWSAVER SURFACE LIGHT

The Crewsaver CSL is a high powered white LED water activated surface mounted lifejacket light. The unit is powered by a Duracell Ultra 123 Lithium/Magnesium Dioxide battery. The minimum and maximum light output levels are in excess of IMO requirements. The light is fitted with a water activated switch, which when immersed in water will start the unit flashing.

The product life of the CSL is clearly marked by an expiry date. This is printed on the end of the CSL. Upon expiry the light should be removed by prising off the plastic securing clip take care not to damage your lifejacket during this procedure. A new CSL should be fitted.

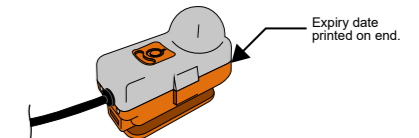

No action by the user is required as the light will switch on automatically when the water-activated switch is fully immersed in water.

Care must be taken when fitting this type of light to ensure that the light is positioned as high as possible on the lifejacket, but that the lead will still remain fully submerged in water.

ROUTINE SERVICE

Units are maintenance free, however the following checks should be made at least annually:

1. Check the expiry date on the end of the light. Replace light if the expiry date has passed.
2. Inspect light for signs of corrosion and damage.
3. Test the light by pressing the switch (see image below). The light must flash, press the light switch again to turn the flashing off (This will not affect the automatic operation of the light). If the light does not flash - the unit has expired - and must be replaced.
4. Operation should also be checked during the lifejackets service.

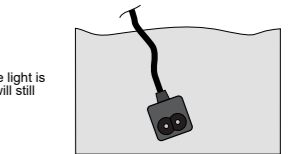

To test the light: Press once to turn on and again to turn off.

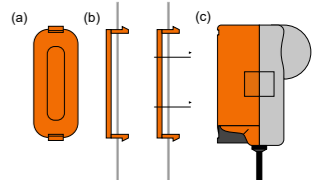

The CSL light is supplied with a fixing clip (a). The clip is to be placed behind the fabric light retainer (b). The light is secured by pressing the clip onto the back of the light (c).

Artwork

MARIN 290 LIFEJACKET

ART0863 12

ADDITIONAL INFORMATION

WARNING: This product must be stored properly, kept in a dry well-ventilated area. A damaged, discoloured, or worn lifejacket should not be used. If you notice any damage, wear, or tear, do not use the lifejacket. If you notice any damage, wear, or tear, do not use the lifejacket. If you notice any damage, wear, or tear, do not use the lifejacket.

REPAIRS: Repairs should not be attempted by the user. Repairs should be performed by a qualified technician. Repairs should not be attempted by the user. Repairs should be performed by a qualified technician. Repairs should not be attempted by the user. Repairs should be performed by a qualified technician.

THIS LIFEJACKET MUST BE SERVICED AT LEAST ONCE A YEAR UNDER NORMAL USE OR AS RECOMMENDED SERVICE INTERVALS.

IMPORTANT: THE LIFESPAN OF THE PRODUCT IS 10 YEARS WITH SERVICING YEARLY EXTRA 4 YEARS WITH SERVICING EVERY 6 MONTHS.

WARNING: Always use the lifejacket in accordance with the instructions and do not use it if it has already been inflated or used.

WARNING: Never use a lifejacket as a cushion or in any other way. It may cause damage.

WARNING: The lifejacket is intended for use in calm water. Do not use it in rough weather conditions. They must be kept away from children and not released.

MARIN 290 LIFEJACKET

GENERAL INFORMATION: The lifejacket is designed for use in calm water. It is not intended for use in rough weather conditions. It is not intended for use in rough weather conditions. It is not intended for use in rough weather conditions.

GENERAL INFORMATION: The lifejacket is designed for use in calm water. It is not intended for use in rough weather conditions. It is not intended for use in rough weather conditions. It is not intended for use in rough weather conditions.

GENERAL INFORMATION: The lifejacket is designed for use in calm water. It is not intended for use in rough weather conditions. It is not intended for use in rough weather conditions. It is not intended for use in rough weather conditions.

GENERAL INFORMATION: The lifejacket is designed for use in calm water. It is not intended for use in rough weather conditions. It is not intended for use in rough weather conditions. It is not intended for use in rough weather conditions.

MARIN 290 BODY ARMOUR ATTACHMENT

MARIN 290 STAND-ALONE LIFEJACKET

MANUFACTURER'S INFORMATION

IMPORTANT: THE LIFESPAN OF THE PRODUCT IS 10 YEARS WITH SERVICING YEARLY EXTRA 4 YEARS WITH SERVICING EVERY 6 MONTHS.

Product Description

MARIN 290 User Manual ONLINE VERSION

Changes from Previous Issue:

Date	Specification Issue Number	PAA Reference No.	Changes to Previous Issue
06/04/2023	i1		First Issue
18/06/2024	i2	PAA-00160	Attachment to body armour instructions updated
21/06/2024	i3	PAA-00161	Spec numbers corrected

Authorised by:



Crewsaver
Safer By Design

USER MANUAL



MARIN 290 LIFEJACKET

ART0603 13

MARIN 290 LIFEJACKET

GENERAL DESCRIPTION

The MARIN 290 range of Lifejackets are designed for use by the forces. The high buoyancy level provides added protection when heavy work gear, equipment or clothing is worn. These Lifejackets have a single chamber fitted with a 60g CO₂ cylinder ensuring full buoyancy of 290N is achieved during inflation. The MARIN 290 Lifejackets have a yellow Polyurethane coated nylon bladder with x8 pieces of reflective tape (covered by default), a whistle located on the edge of the bladder and an MED approved light.

The MARIN 290 Lifejackets are available with an automatic firing mechanism. The automatic version can be converted to manual operation by simply covering the automatic capsule with a sealing cap (included in the cover).

The MARIN 290 can be worn attached to body armour, through the use of MOLLE webbing. It can also be worn as a standalone lifejacket with the included waistbelt and crotch straps attached.

STANDARD AUTOMATIC INFLATION

Automatic inflation of the Lifejacket is achieved by an efficient and lightweight automatic operating unit with replaceable capsule and CO₂ cylinder. Tests on this component have constantly shown 4 second inflation times from complete immersion. This unit can be manually operated by pulling down on the beaded handle located on the right hand side of the jacket.

MANUAL GAS INFLATION

The gas cylinder is fired manually by pulling the beaded handle located on the right hand side of the cover.

ORAL INFLATION

The lifejacket incorporates a mouth inflation tube for oral topping up and to allow for deflation after use.

LIGHT

The lifejacket is fitted with a MED approved light. No action by the user is required as the light will switch on automatically when the water-activated switch is fully immersed in water. The light can be turned off by pressing the button on top of the light unit.

**IMPORTANT
ONLY AUTHORISED PERSONNEL ARE PERMITTED TO
CARRY OUT THESE OPERATIONS**

BEFORE USE

These models are ready for use when purchased. However, the following checks must be made:

The operating head can be accessed by unzipping the zip located on the top neck part of the cover. Check that the automatic firing capsule (C) is screwed fully onto the operating mechanism (B). Ensure that the capsule (C) has not been fired inadvertently by checking that the bottom indicators show green (D). Also check the expiry date on the side of the capsule. Do not use a capsule that is out of date. Check the CO₂ cylinder (A) is securely screwed into the operating mechanism with EXOLOK mechanism and label (F) and fit mesh sleeve (G). Check that the top indicator (D) show green. Ensure pull handle (E) is located in the garage in the jacket cover and cord is not tangled or damaged.

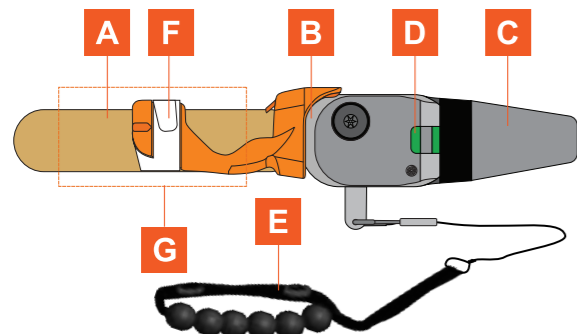

ADDITIONAL INFORMATION

STORAGE

At all times the jacket must be stored, preferably hung up, in a dry well ventilated area. Automatic lifejackets, exposed to any form of dampness during storage could result in spontaneous inflation. If the jacket becomes wet, it is necessary to unfold the jacket from its cover. Remove the automatic capsules if fitted and allow the lifejacket to dry naturally in a warm dry atmosphere. The automatic capsules should be stored in a dry place whilst the jacket is being dried out. Once the jacket is dry, the capsules may be refitted and the jacket repacked (See repacking instructions).

GENERAL

Only approved personnel should instruct on the correct donning, operation of inflation mechanisms and oral tube inflation of the lifejacket.

THIS LIFEJACKET MUST BE SERVICED, AT LEAST ONCE A YEAR UNDER NORMAL USE, BY AN APPROVED SERVICE AGENT.

IMPORTANT: THE LIFESPAN OF THE PRODUCT IS 10-YEARS WITH SERVICING YEARLY. EXTRA 4 YEARS WITH SERVICING EVERY 6 MONTHS.

WARNING: inflating your lifejacket using CO₂ inflation could over pressurise and damage the lifejacket if it has already been inflated orally.

Never use a lifejacket as a cushion or in any other way likely to cause damage.

WARNING: This lifejacket is inflated by a CO₂ gas cylinder! Gas cylinders are dangerous goods. They must be kept away from children and not misused.



Crewsaver

Survitec House, Lederle Lane, Gosport, Hampshire PO13 0FZ
Tel: +44(0) 1329 820000
Web: www.crewsaver.com

survitec

MARIN 290 BODY ARMOUR ATTACHMENT

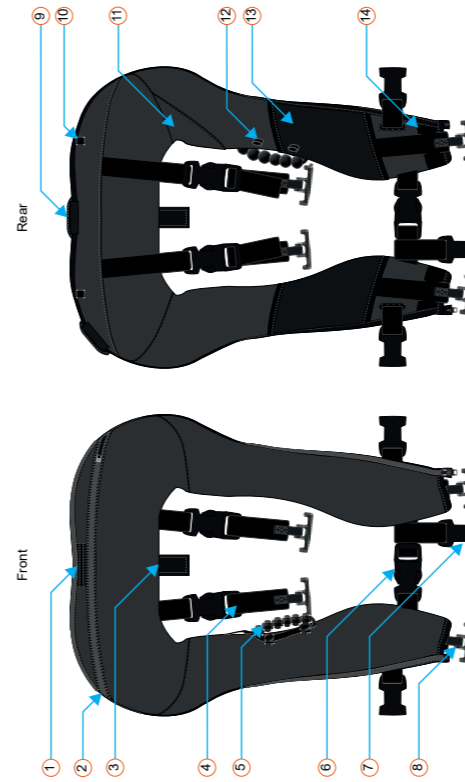

1. Glowstick pocket.
2. Ring mechanism inspection zip.
3. Ring mechanism inspection zip.
4. Ring mechanism inspection zip.
5. Ring mechanism inspection zip.
6. Ring mechanism inspection zip.
7. Ring mechanism inspection zip.
8. Ring mechanism inspection zip.
9. Burst point tabs.
10. Ring mechanism inspection zip.
11. Ring mechanism inspection zip.
12. Ring mechanism inspection zip.
13. Ring mechanism inspection zip.
14. Ring mechanism inspection zip.

MARIN 290 STANDALONE LIFEJACKET

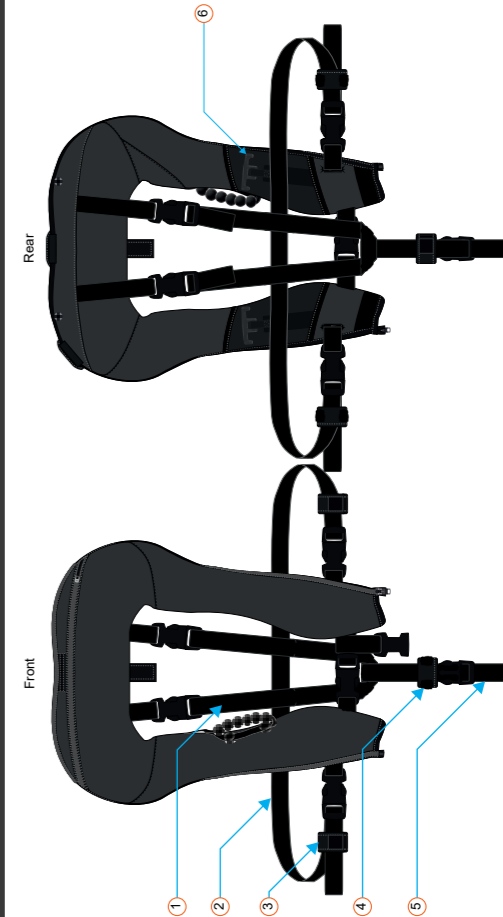

1. Rear crotch strap attachment clips.
2. Waist belt webbing.
3. Waist belt webbing ties.
4. Crotch strap webbing ties.
5. Crotch strap clip.
6. Front body armour webbing attachment clips tucked into ties.

**** CROTCH STRAP OPTIONAL**

MANUFACTURERS INFORMATION

The service label for the jacket it attached to the back neck of the bladder and it is visible when the inspection pocket is opened.

The label contains the service history and serial number of the jacket. The serial number also includes the date of manufacture.

Year
Month
Serial Number



**IMPORTANT
THE LIFESPAN OF THE PRODUCT IS 10-YEARS WITH SERVICING YEARLY.
EXTRA 4 YEARS WITH SERVICING EVERY 6 MONTHS**

Included in the jacket is R16932 UMA8080 Pro Sensor Elite Sealing Cap and it allows the automatic mechanism to be converted to a manual mechanism by fitting the cap over the end of the firing mechanism. The cap sits within a mesh pocket on the inside top of the jacket.

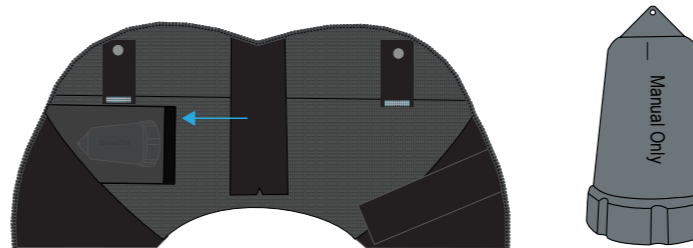

TESTING YOUR LIFEJACKET

Train yourself in the use of the device. In an emergency, there is no time to learn how the equipment works. Crewsaver recommend that you try your Lifejacket to ascertain its performance before use in an emergency. This will also help familiarise yourself with the product.

When trying out your Lifejacket, remember that you may need replacement parts or rearming kits to get your Lifejacket ready for use again.

**IMPORTANT
ONLY AUTHORISED PERSONNEL ARE PERMITTED TO
CARRY OUT THESE OPERATIONS**

AFTER USE

General:

a) Deflate the jacket completely by reversing the cap of the oral inflation tube and inserting it into the end of the tube. Remove as much gas as possible by squeezing the jacket. If the jacket was inflated by the CO₂ cylinder, care must be taken not to breathe in the expelled gas, otherwise discomfort in breathing will be experienced.

DO NOT USE A VACUUM PUMP TO DEFLATE THE LIFEJACKET

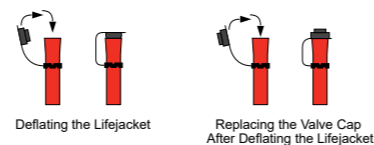

b) Unscrew the fired capsule before removing the spent cylinder.

c) If the Lifejacket has been in salt water or contaminated water, it is essential to rinse out in fresh water first. Hang the unfolded Lifejacket in a warm and dry atmosphere. Allow to dry out completely.

d) Once dry, inflate by mouth and check for damage. If damage has occurred, return to Crewsaver for repair or to their accredited agent. DO NOT ATTEMPT ANY REPAIRS YOURSELF OR ANY RIGHTS UNDER MANUFACTURERS GUARANTEE WILL BECOME VOID. Providing the jacket is sound, a new cylinder and capsule may be fitted to the lifejacket.

e) The MARIN 290 is fitted with an approved light. If the light has reached the expiry date the light must be replaced with a new approved unit.

f) The Lifejacket should now be repacked ready for use (see repacking instructions).

RE-ARMING YOUR AUTOMATIC OPERATING MECHANISM

Always re-arm your lifejacket ready for use before you stow it away. The operating mechanism must be thoroughly dried before re-arming. When re-arming your lifejacket it is important you use only Crewsaver supplied components. For your nearest supplier contact Crewsaver or see www.crewsaver.com

Take the new automatic firing capsule and screw onto the operating mechanism in a clockwise direction. Screw tightly ensuring there is no gap between the capsule and the base of the operating mechanism.

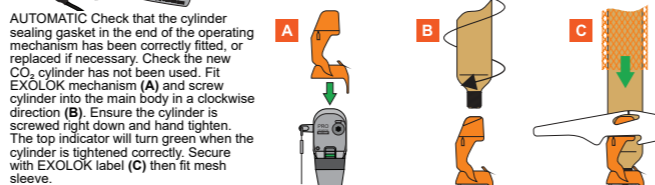

AUTOMATIC Check that the cylinder sealing gasket in the end of the operating mechanism has been correctly fitted, or replaced if necessary. Check the new CO₂ cylinder has not been used. Fit EXOLOK mechanism (A) and screw cylinder into the main body in a clockwise direction (B). Ensure the cylinder is screwed right down and hand tighten. The top indicator will turn green when the cylinder is tightened correctly. Secure with EXOLOK label (C) then fit mesh sleeve.

The operating mechanism is now re-armed. Both indicators should show green. DO NOT USE if either indicator is red. See www.uml.co.uk for more details on the UML Pro-Elite Mechanism.

CREWSAVER SURFACE LIGHT

The Crewsaver CSL is a high powered white LED water activated surface mounted lifejacket light. The unit is powered by a Duracell Ultra 123 Lithium/Magnesium Dioxide battery. The minimum and maximum light output levels are in excess of IMO requirements. The light is fitted with a water activated switch, which when immersed in water will start the unit flashing.

The product life of the CSL is clearly marked by an expiry date. This is printed on the end of the CSL. Upon expiry the light should be removed by prising off the plastic securing clip take care not to damage your lifejacket during this procedure. A new CSL should be fitted.

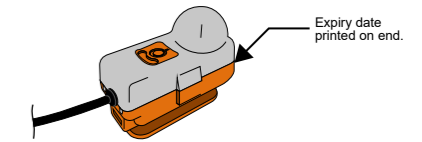

No action by the user is required as the light will switch on automatically when the water-activated switch is fully immersed in water.

Care must be taken when fitting this type of light to ensure that the light is positioned as high as possible on the lifejacket, but that the lead will still remain fully submerged in water.

ROUTINE SERVICE

Units are maintenance free, however the following checks should be made at least annually:

1. Check the expiry date on the end of the light. Replace light if the expiry date has passed.
2. Inspect light for signs of corrosion and damage.
3. Test the light by pressing the switch (see image below). The light must flash, press the light switch again to turn the flashing off (This will not affect the automatic operation of the light). If the light does not flash - the unit has expired - and must be replaced.
4. Operation should also be checked during the lifejackets service.

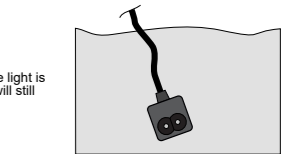

To test the light: Press once to turn on and again to turn off.

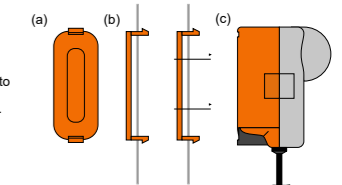

The CSL light is supplied with a fixing clip (a). The clip is to be placed behind the fabric light retainer (b). The light is secured by pressing the clip onto the back of the light (c).

MARIN 290 STANDALONE DONNING



BACK NECK TAB

On the back neck of the jacket is a black fabric tab (highlighted) which indicates if the jacket when fitted is in the correct position. When the user is correctly wearing the jacket the tab should sit horizontally up against the back of the users neck.

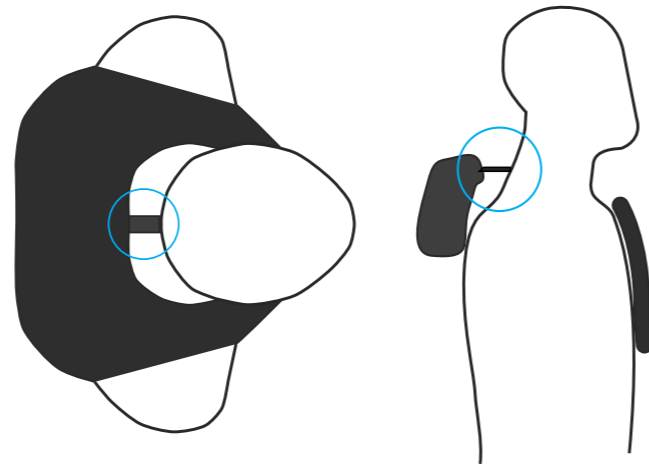

If the back neck tab is not in the correct position, as shown above, adjust the position of the jacket using the back buckles and webbing (highlighted).



CYLINDER PLACEMENT

IMPORTANT
ENSURE THE CYLINDER AND FIRING MECHANISM ARE UNDERNEATH THE BLADDER RETAINING STRAP (HIGHLIGHTED)

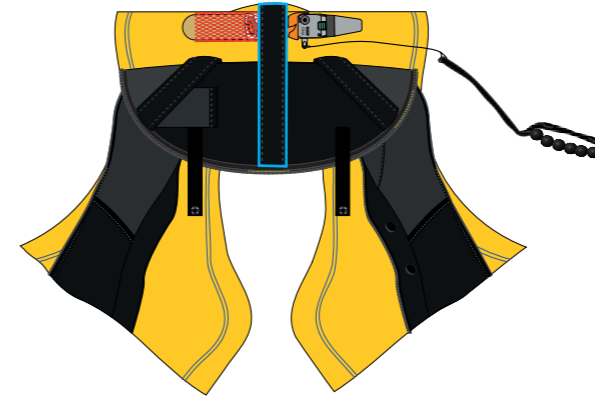

IMPORTANT
ENSURE THE CYLINDER AND FIRING MECHANISM ARE INSERTED INTO THE STRAPS HIGHLIGHTED BELOW

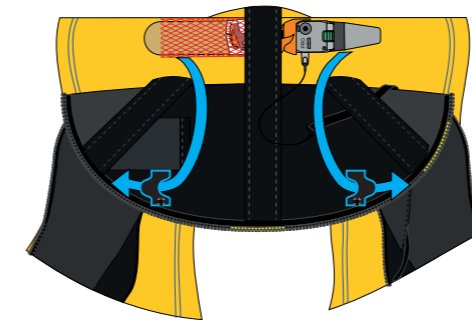

WARNING
THE INSPECTION ZIP CANNOT BE OPEN FOR INFLATION

PULL HANDLE POSITION

There are two potential positions for the pull handle, FRONT and BACK.
OPTION 1: FRONT

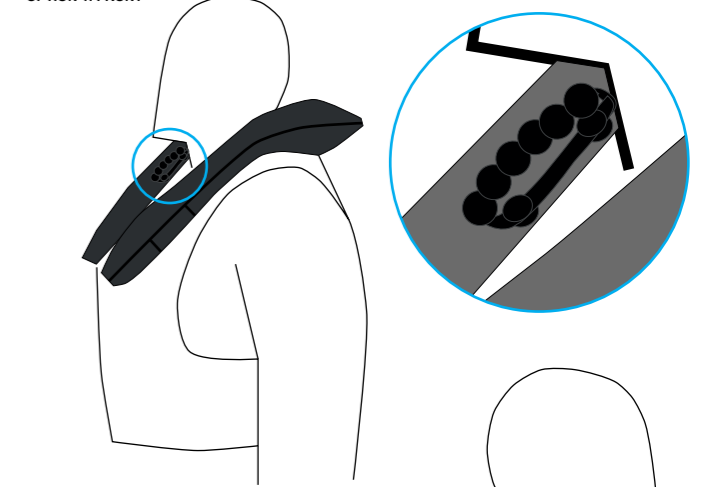

OPTION 2: BACK

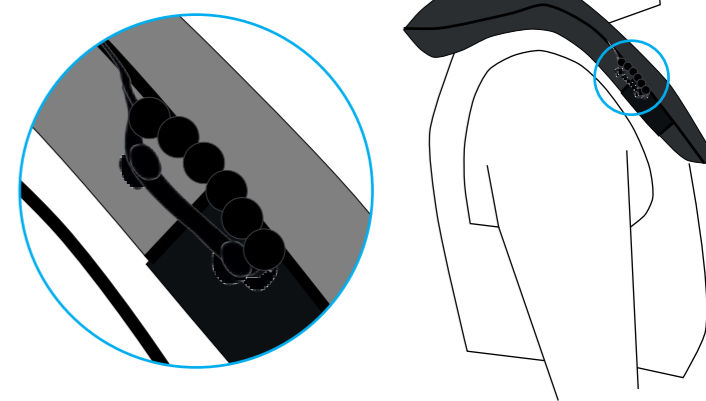

MARIN 290 FITTED ON BODY ARMOUR

The jacket can be fitted on body armour and can worn at the same as a magazine pocket.

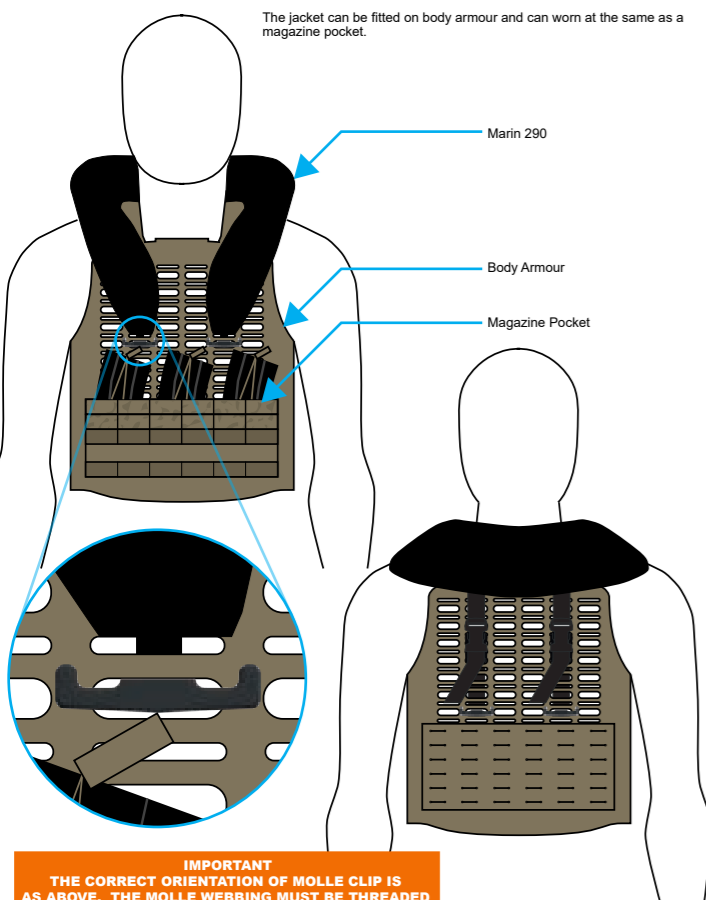

PLACEMENT ON BODY ARMOUR (FRONT)

To fit the front of jacket onto the body armour from the top right and left large spaces (HIGHLIGHTED) COUNT 1 IN. At this point thread the MOLLE clip through. Insert the MOLLE clip back through the 2 DOWN space and thread through the webbing on the jacket. Thread back through 3 DOWN and then through 4 DOWN.

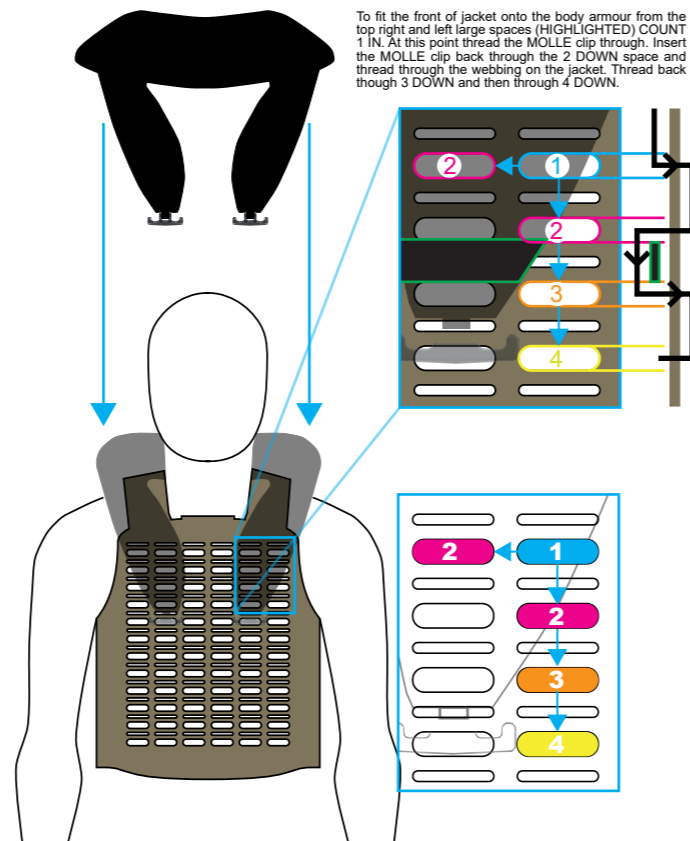

PLACEMENT ON BODY ARMOUR (BACK)

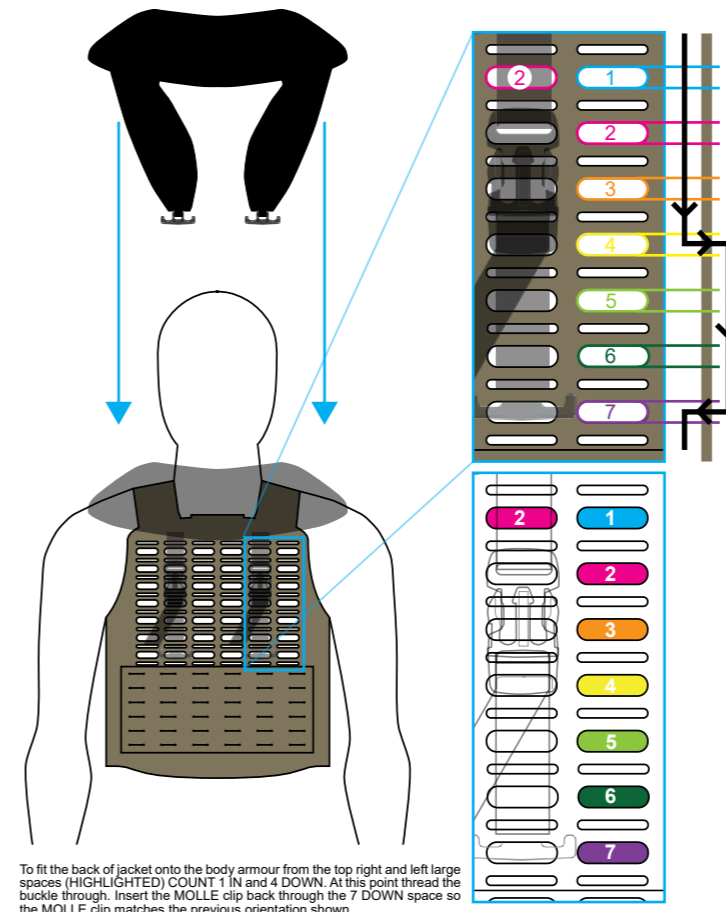

To fit the back of jacket onto the body armour from the top right and left large spaces (HIGHLIGHTED) COUNT 1 IN and 4 DOWN. At this point thread the buckle through. Insert the MOLLE clip back through the 7 DOWN space so the MOLLE clip matches the previous orientation shown.

MAGAZINE POCKET PLACEMENT

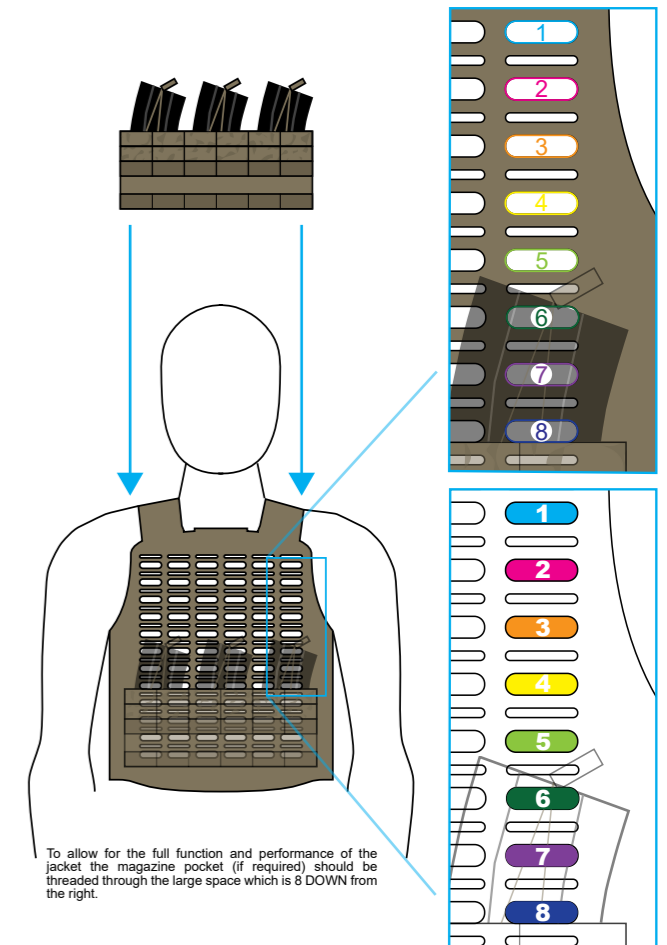

To allow for the full function and performance of the jacket the magazine pocket (if required) should be threaded through the large space which is 8 DOWN from the right.

IMPORTANT
THE CORRECT ORIENTATION OF MOLLE CLIP IS AS ABOVE. THE MOLLE WEBBING MUST BE THREADED UNDERNEATH AND THE CLIP MUST BE IN FRONT

MARIN 290 BODY ARMOUR ATTACHMENT

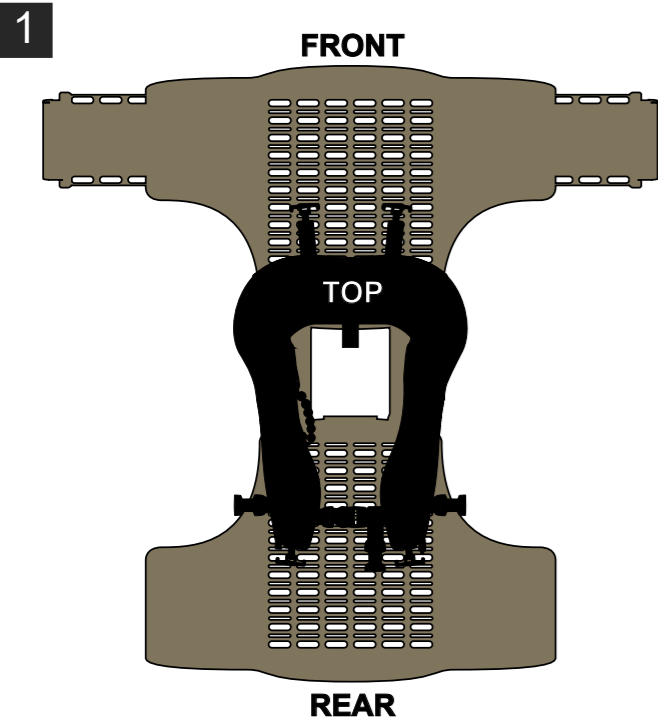

Lay body armour out flat and position MARIN 290 on top.

MARIN 290 BODY ARMOUR ATTACHMENT

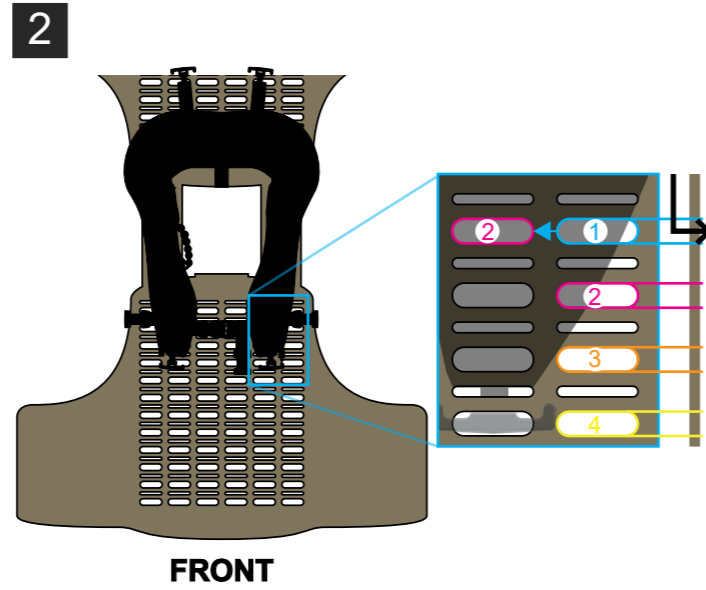

To fit the front of jacket onto the body armour from the top right and left large spaces (HIGHLIGHTED) COUNT 1 IN and thread the buckle through

MARIN 290 BODY ARMOUR ATTACHMENT

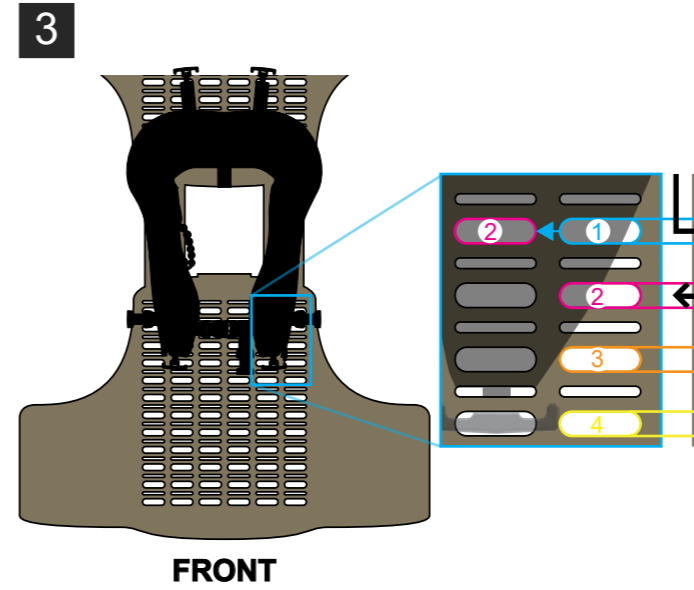

Thread the buckle back through the 2 DOWN space.

MARIN 290 BODY ARMOUR ATTACHMENT

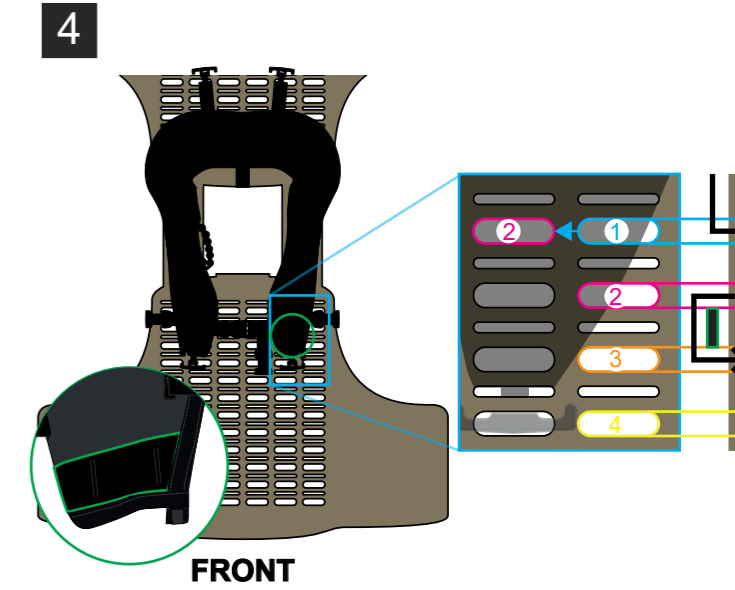

Thread the buckle through the highlighted piece of webbing on the jacket and back through the 3 DOWN space.

MARIN 290 BODY ARMOUR ATTACHMENT

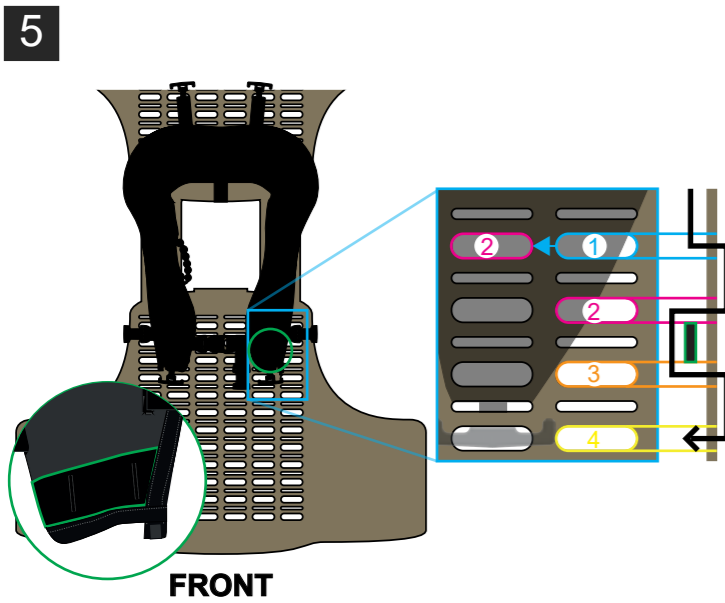

Thread the buckle back through the 4 DOWN space.

MARIN 290 BODY ARMOUR ATTACHMENT

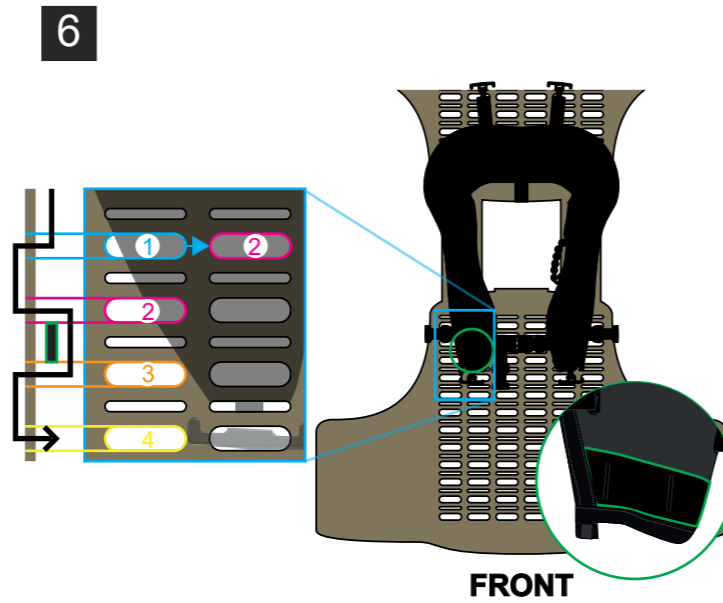

Repeat for other side

MARIN 290 BODY ARMOUR ATTACHMENT

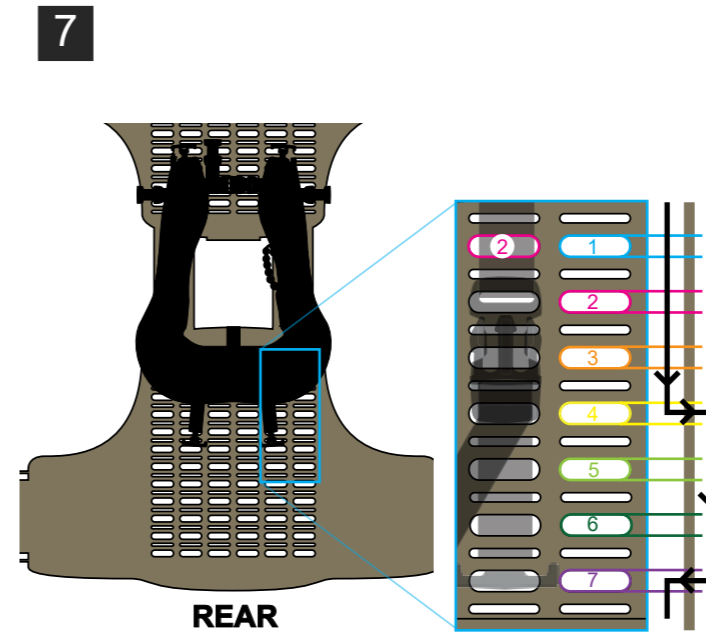

To fit the front of jacket onto the body armour from the top right and left large spaces (HIGHLIGHTED) COUNT 1 IN and 4 DOWN. At this point thread the buckle through. Insert the MOLLE clip back through the 7 DOWN space so the MOLLE clip matches the previous orientation shown.

MARIN 290 BODY ARMOUR ATTACHMENT

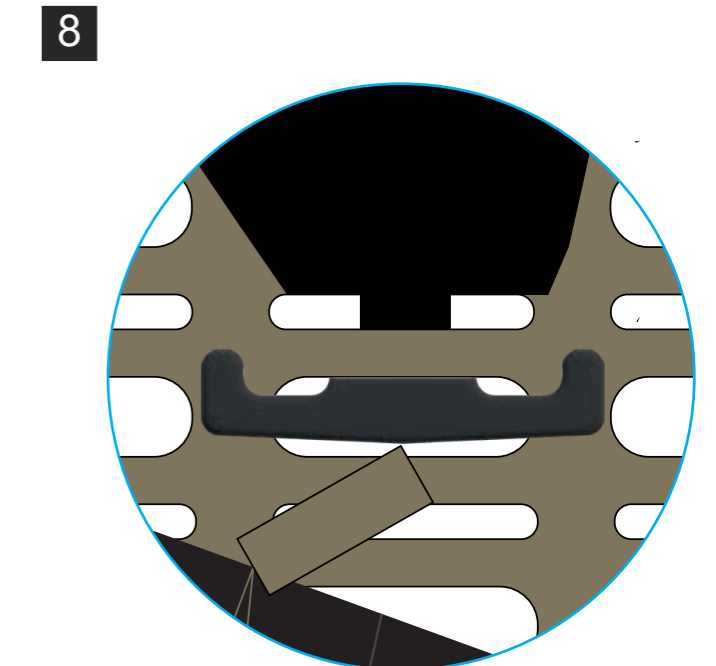

Check all MOLLE clips follow the orientations shown above.

MARIN 290 BODY ARMOUR ATTACHMENT

9

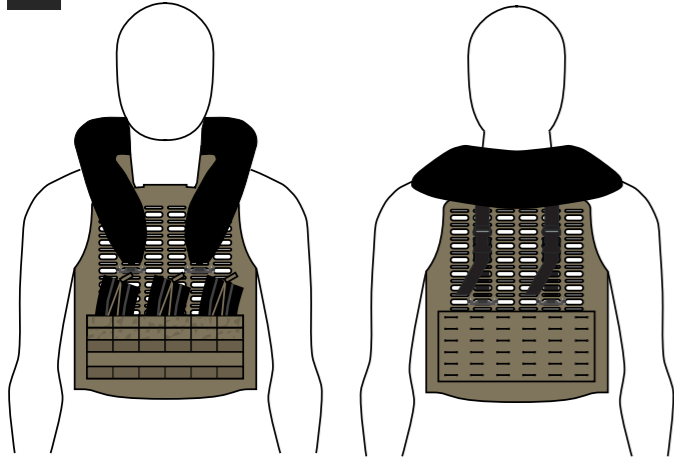

After jacket has been secured, put on the body armour/jacket.

MARIN 290 BODY ARMOUR ATTACHMENT

10

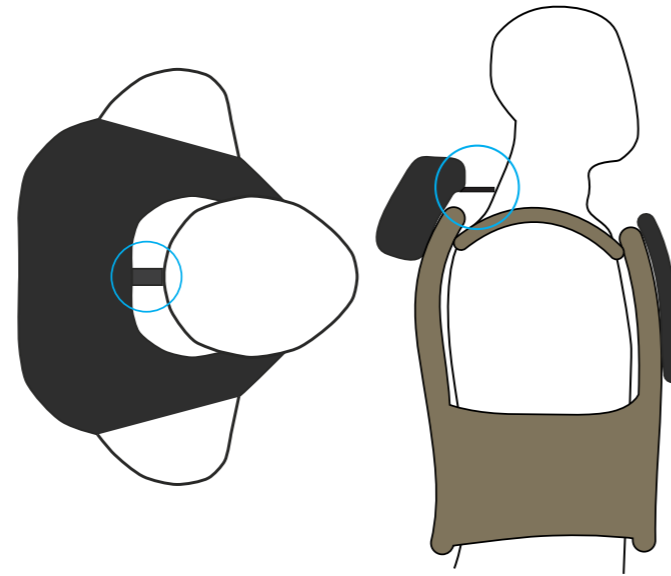

Use the Back Neck Tab to ensure the jacket is fitted correctly.

MARIN 290 BODY ARMOUR ATTACHMENT

11

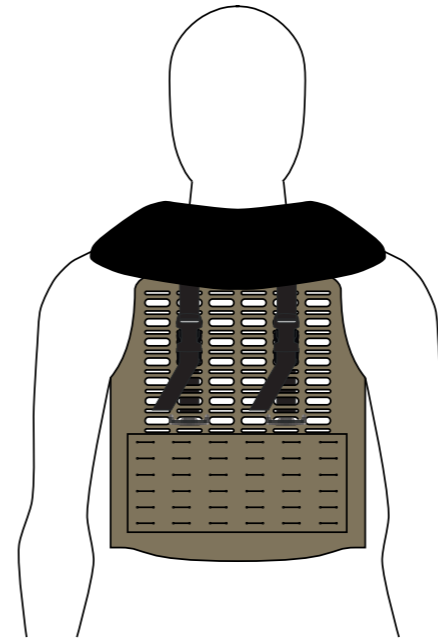

Use the Back Adjuster Buckles, if needed, to allow the jacket to sit in the correct position.

MARIN 290 BODY ARMOUR ATTACHMENT

12

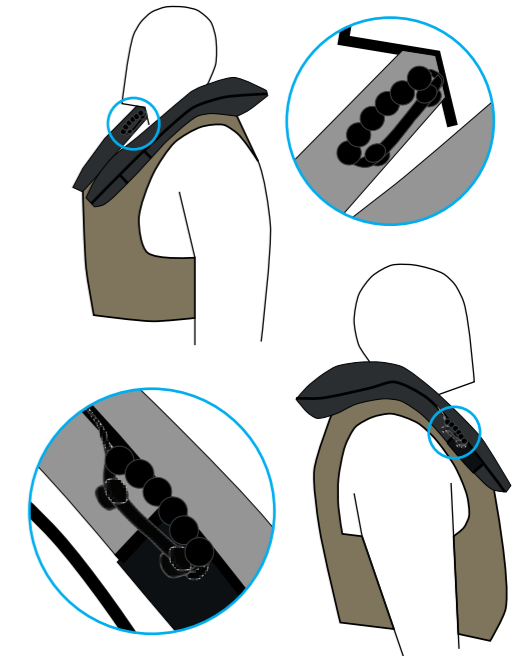

Check that the Pull Handle is in the correct position, as there are two options.

MARIN 290 PACKING INSTRUCTIONS

1



Before packing, ENSURE the jacket is in the orientation above with the panels and lights fitted correctly.

MARIN 290 PACKING INSTRUCTIONS

2

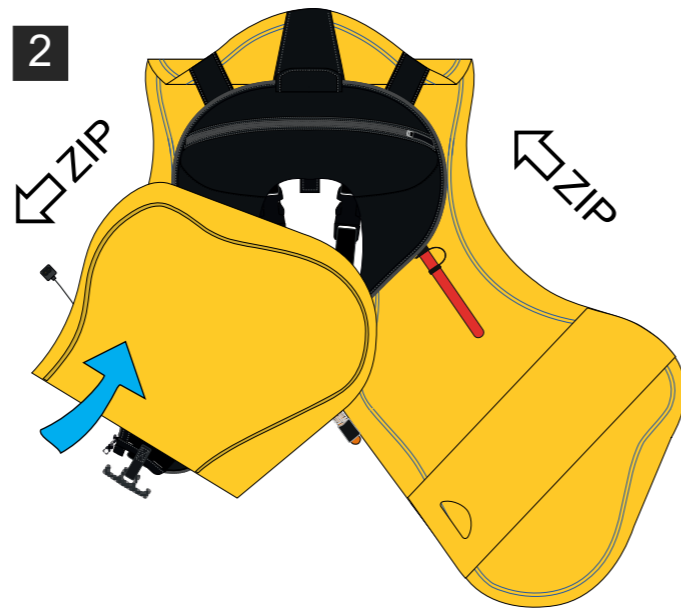

Ensure zip slider is in the starting position.
FOLD up the bottom left of the bladder as far as it will go.

MARIN 290 PACKING INSTRUCTIONS

3

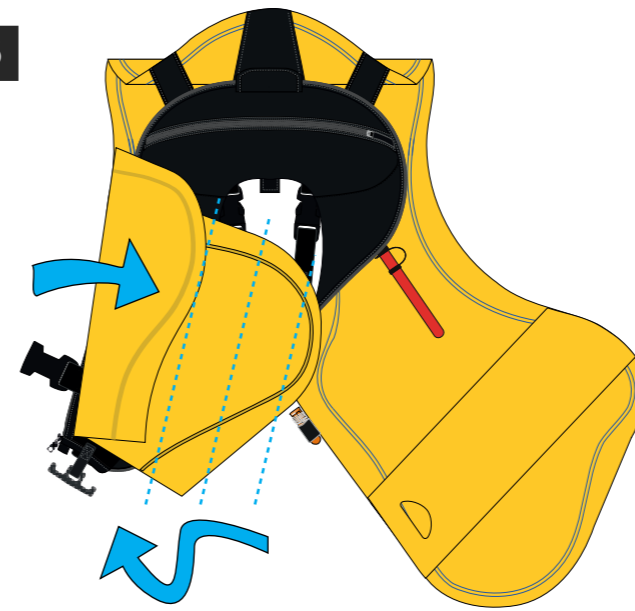

FOLD the outer left side in towards the centre as far as it will go.
CONCERTINA the inner left side three times towards the outer left side.

MARIN 290 PACKING INSTRUCTIONS

4

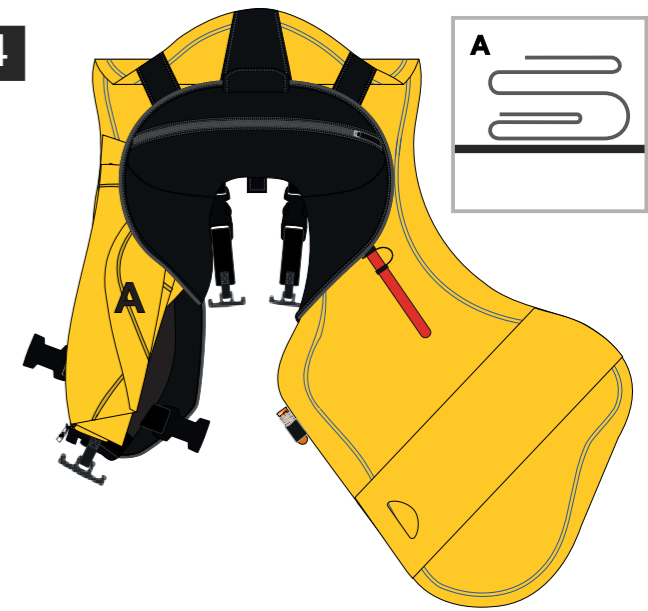

CONCERTINA fold should pack like diagram A.
ZIP up left hand side of cover.

MARIN 290 PACKING INSTRUCTIONS

5

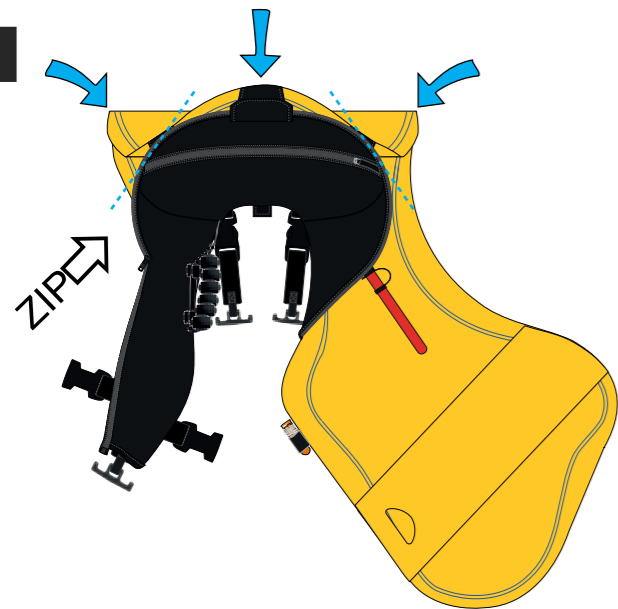

CONCERTINA the top of the bladder down as far as it will go.
FOLD in both of the corners of the bladder.

MARIN 290 PACKING INSTRUCTIONS

6

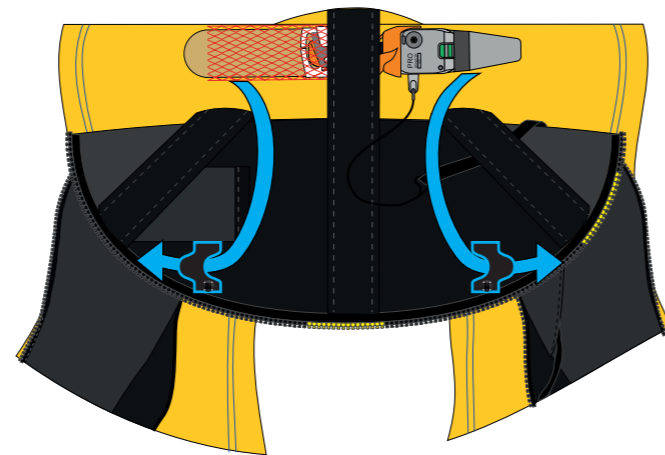

Before zipping, ENSURE the cylinder is being held by the STRAPS inside the cover.

MARIN 290 PACKING INSTRUCTIONS

7

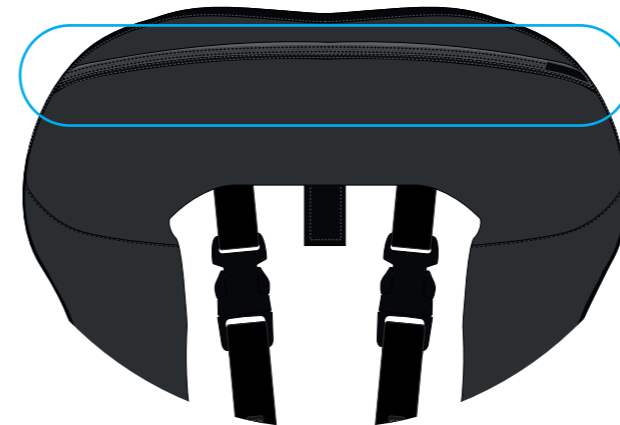

ENSURE the inspection zip is CLOSED.

MARIN 290 PACKING INSTRUCTIONS

8

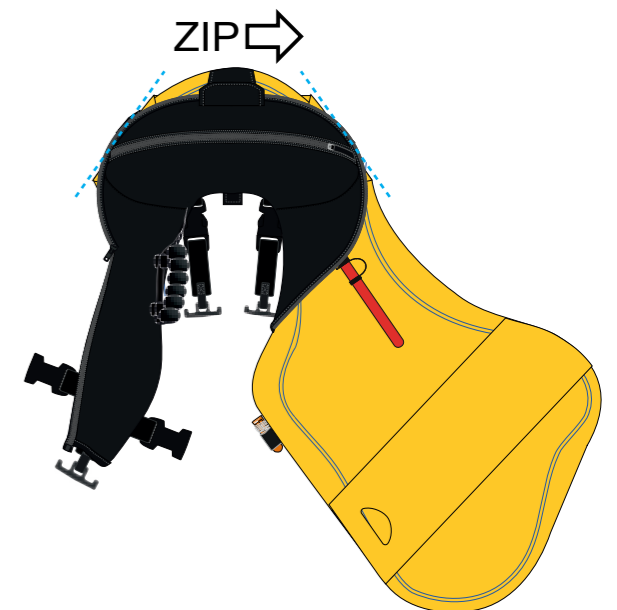

ZIP up the top of the cover.

9

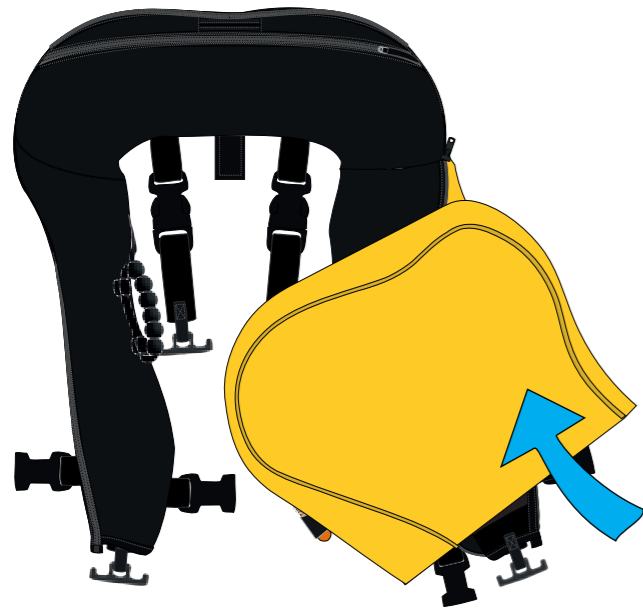

FOLD up the bottom right of the bladder as far as it will go.

10

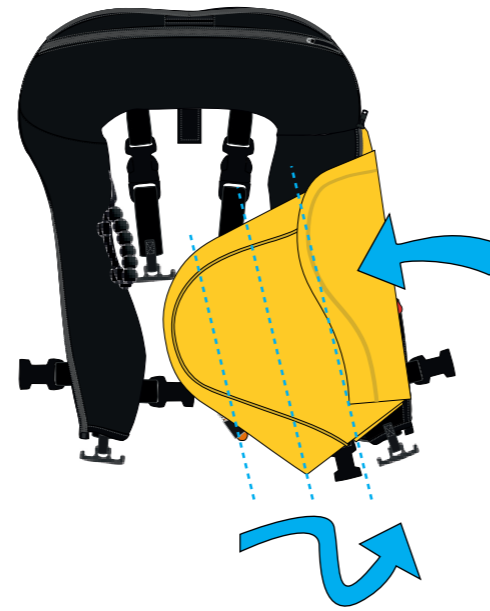

FOLD the outer right side in towards the centre as far as it will go.
CONCERTINA the inner right side three times towards the outer right side.

11

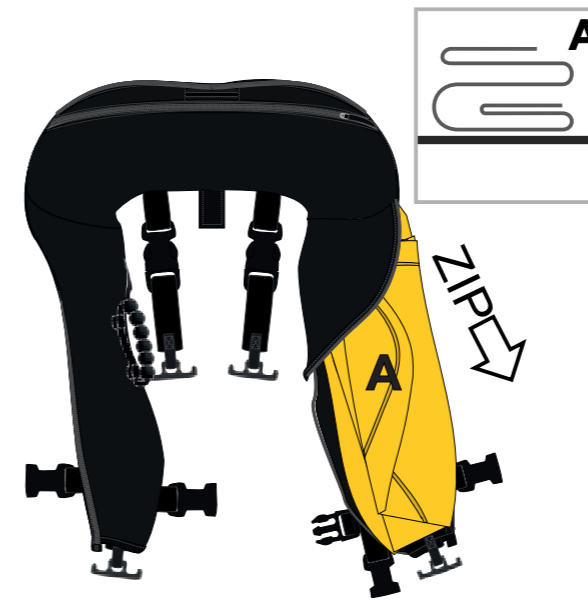

CONCERTINA fold should pack like diagram A.
Zip up right hand side of cover to complete packing.

12

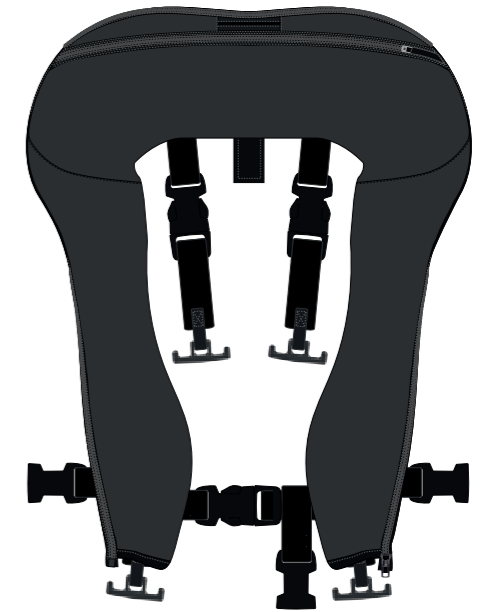

ENSURE the packed jacket resembles the image above